

# Terminal 91 Lighting Upgrades



© 2008 King County

The information included on this map has been compiled by King County staff from a variety of sources and is subject to change without notice. King County makes no representations or warranties, express or implied, as to accuracy, completeness, timeliness, or rights to the use of such information. This document is not intended for use as a survey product. King County shall not be liable for any general, special, indirect, incidental, or consequential damages including, but not limited to, lost revenues or lost profits resulting from the use or misuse of the information contained on this map. Any sale of this map or information on this map is prohibited except by written permission of King County.

Date: 9/10/2013

Source: King County MAP - Property Information (<http://www.metrokc.gov/GIS/IMAP>)





**GENERAL NOTES:**

- EXISTING LIGHT POLES, CIRCUITING AND CONTROLS SHALL REMAIN, BE PROTECTED AND MODIFIED TO ACCEPT NEW LED TYPE LIGHTING LUMINAIRES AND RF TYPE LIGHTING CONTROLS.
- VERIFY AND DOCUMENT EXISTING LIGHTING LUMINAIRE AND CONTROLS OPERATION PRIOR TO LUMINAIRE REPLACEMENT.

**SHEET NOTES:**

- REPLACE EXISTING LIGHT POLE LUMINAIRES WITH NEW LED TYPE LIGHTING LUMINAIRE, EXCEPT WHERE OTHERWISE INDICATED.
- PROVIDE NEW RF LIGHTING CONTROLS TO PROVIDE INDIVIDUAL LIGHTING LUMINAIRE ON-OFF-DIMMING CONTROLS.
- PROVIDE MOTION SENSOR CONTROLLER TO LOWER LIGHT OUTPUT DURING INACTIVITY AND RAISE LIGHT OUTPUT DURING ACTIVITY.
- PROVIDE NEW RF LIGHTING CONTROLS TO OVERRIDE ON-OFF EXISTING LIGHTING CONTACTOR AND PHOTOCCELL CONTROLS.

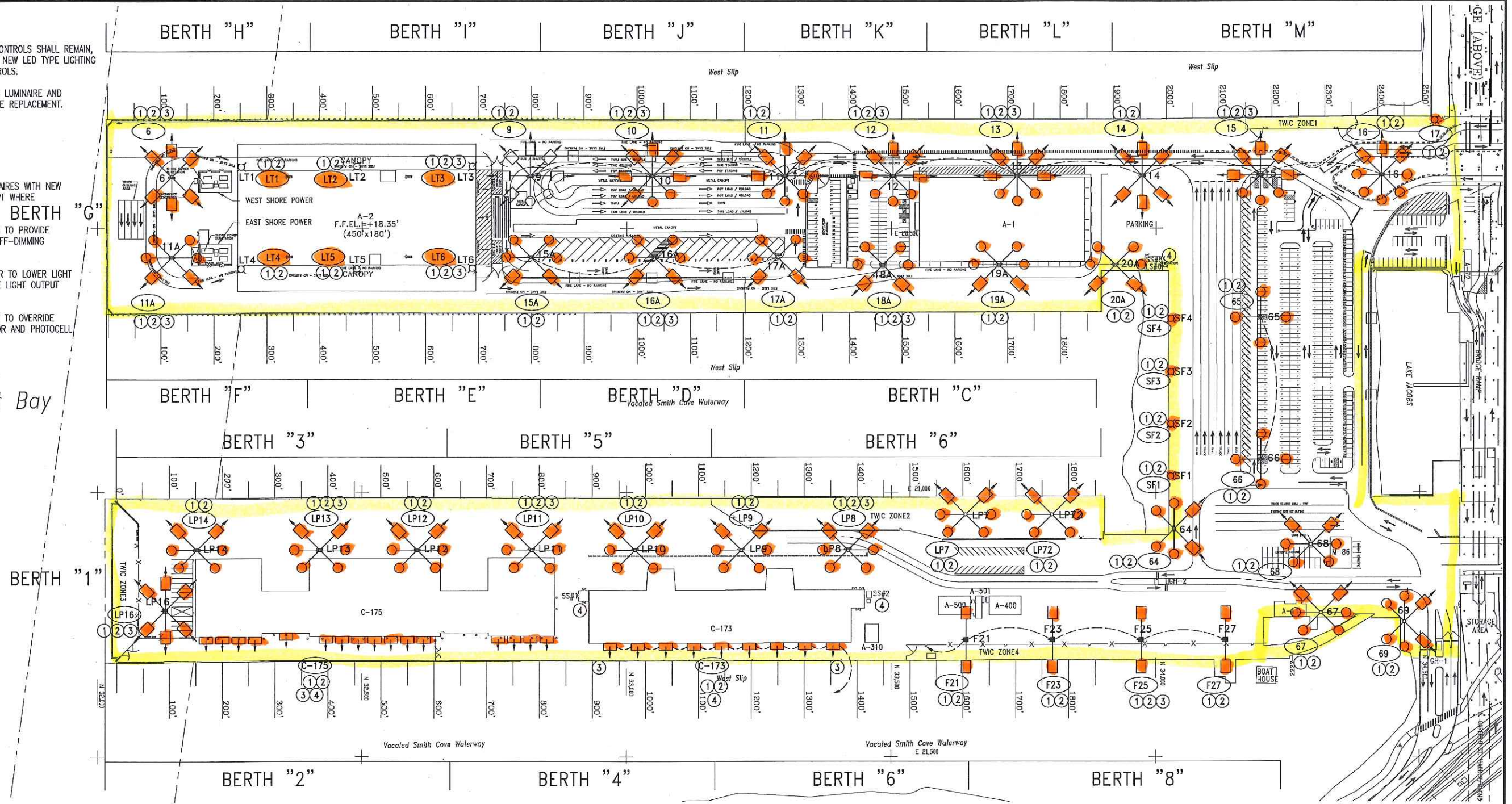

Elliott Bay

**LIGHTING LEGEND**

- ⊗ EXISTING LIGHT POLE
- EXISTING WALL MOUNTED LIGHT

**PLAN**

YARD LIGHTING  
PIER 90/91  
SCALE: 1"=100'



CALL 2 DAYS  
BEFORE YOU DIG  
1-800-424-5555

If this drawing is not 34x22, it is a reduced print - scale accordingly

<p>3009 113th Ave NE, Suite 100 Bellevue WA 98004 425.628.6000 woodharbinger.com</p>	PROJECT ENGR/ARCH: M.J.W. DESIGNER: M.J.W. DRAWN BY: ALB SCALE: 1"=100' DATE: 05-##-13 CHECKED BY: M.J.W. CHECKED/APPROVED BY: DCB		REVISIONS <table border="1" style="width: 100%; border-collapse: collapse; font-size: 8px;"> <thead> <tr> <th>NO.</th> <th>DATE</th> <th>BY</th> <th>DESCRIPTION</th> <th>APP'D</th> <th>NO.</th> <th>DATE</th> <th>BY</th> <th>DESCRIPTION</th> <th>APP'D</th> </tr> </thead> <tbody> <tr> <td> </td> <td> </td> <td> </td> <td> </td> <td> </td> <td> </td> <td> </td> <td> </td> <td> </td> <td> </td> </tr> </tbody> </table>	NO.	DATE	BY	DESCRIPTION	APP'D	NO.	DATE	BY	DESCRIPTION	APP'D											PROJECT MANAGER: ROBERT HOYMAN PROJECT ENGINEER: DESIGN ENGINEER: DRAWN BY: AL GRANT SCALE: DATE: MAY, 2013 CHECKED/APPROVED BY: ROBERT HOYMAN	<p><b>Port of Seattle</b> PROJECT: MARINE FACILITIES TERMINAL 91 - PIERS 90 &amp; 91 YARD LIGHTING UPGRADE SHEET TITLE: PIER LIGHTING SITE PLAN</p>	WORK PROJECT NO. XXXXXX CONSULTANT'S NO. PORT OF SEATTLE NO. E1.00
	NO.	DATE	BY	DESCRIPTION	APP'D	NO.	DATE	BY	DESCRIPTION	APP'D																



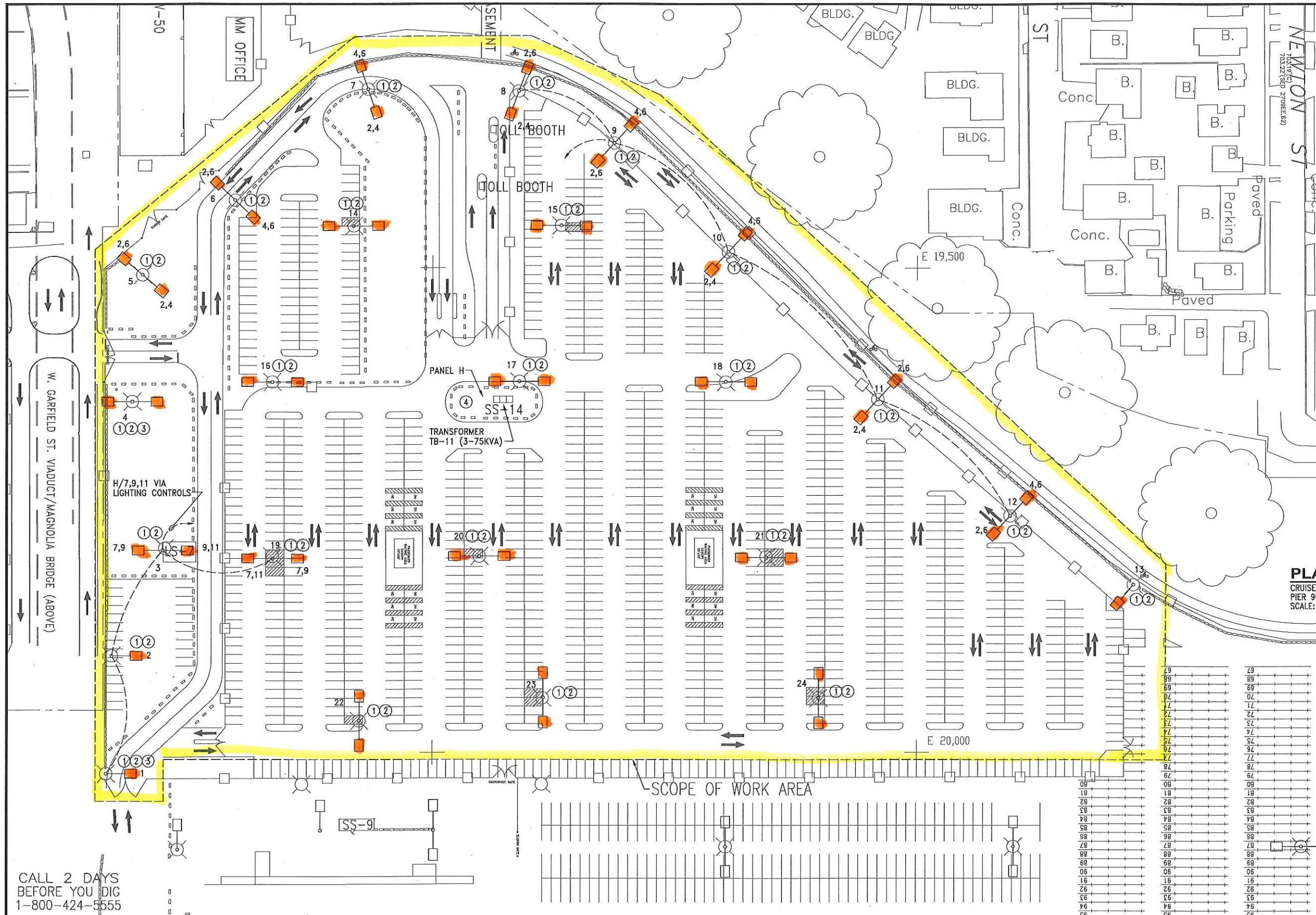

- GENERAL NOTES:**
- EXISTING LIGHT POLES, CIRCUITING AND CONTROLS SHALL REMAIN, BE PROTECTED AND MODIFIED TO ACCEPT NEW LED TYPE LIGHTING LUMINAIRES AND RF TYPE LIGHTING CONTROLS.
  - VERIFY AND DOCUMENT EXISTING LIGHTING LUMINAIRE AND CONTROLS OPERATION PRIOR TO LUMINAIRE REPLACEMENT.

- SHEET NOTES:**
- REPLACE EXISTING LIGHT POLE LUMINAIRES WITH NEW LED TYPE LIGHTING LUMINAIRES.
  - PROVIDE NEW RF LIGHTING CONTROLS TO PROVIDE INDIVIDUAL LIGHT POLE LIGHTING LUMINAIRE ON-OFF-DIMMING CONTROLS.
  - PROVIDE MOTION SENSOR CONTROLLER TO LOWER LIGHT OUTPUT DURING INACTIVITY AND RAISE LIGHT OUTPUT DURING ACTIVITY.
  - PROVIDE NEW RF LIGHTING CONTROLS TO OVERRIDE ON-OFF EXISTING LIGHTING CONTACTOR AND PHOTOCELL CONTROLS.

**PLAN**  
CRUISE PARKING LOT  
PIER 90/91  
SCALE: 1"=50'

- LIGHTING LEGEND**
- EXISTING LIGHT POLE
  - EXISTING WALL MOUNTED LIGHT

CALL 2 DAYS BEFORE YOU DIG  
1-800-424-5555

**Wood Harbinger**  
3009 112th Ave NE,  
Suite 100  
Bellevue WA 98004  
425.628.6000  
woodharbinger.com

PROJECT ENGR/ARCH:  
M.J.W.  
DESIGNER:  
M.J.W.  
DRAWN BY:  
ALB  
SCALE:  
DATE:  
05-##-13  
CHECKED BY:  
M.J.W.  
CHECKER/APPROVED BY:  
DCB

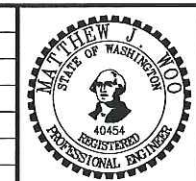

REVISIONS									
NO.	DATE	BY	DESCRIPTION	APP'D	NO.	DATE	BY	DESCRIPTION	APP'D

**AS BUILT AND APPROVED**  
DATE: 11-05-03  
AS CERTIFIED BY THE APPROVAL ON THE COVER SHEET FOR THIS SET, THIS DRAWING REPRESENTS A RECORD OF HOW THE PROJECT WAS CONSTRUCTED AND DOES NOT REPRESENT DESIGN OR CHANGE OF APPROVAL.

PROJECT MANAGER:  
ROBERT HOYMAN  
DESIGN ENGINEER:  
AL GRANT  
SCALE:  
DATE:  
MAY, 2013  
CHECKER/APPROVED BY:  
ROBERT HOYMAN

**Port of Seattle**  
PROJECT:  
SHEET TITLE:

**MARINE FACILITIES**  
**TERMINAL 90 PIER 90/91 YARD LIGHTING UPGRADE**

WORK PROJECT NO.  
XXXXXX  
CONSULTANT'S NO.  
PORT OF SEATTLE NO.

If this drawing is not 34x22, it is a reduced print - scale accordingly